

EXTERIOR PANELS

MR-24[®]

MR-24[®] is a 600 mm wide factory roll-formed panel with two 50 mm high major corrugations, 70 mm to the top of the seam. Panel lengths are only restricted by transportation limits. The flat of the panel contains cross flutes at 150 mm centres perpendicular to the major corrugations, to improve walkability. Panel material is 0.66 mm thick aluminum/zinc coated steel with a minimum yield strength of 320 N/mm². The coating consist of 55% Aluminum, 1.5% Silica, 43.5% Zinc. The aluminum /zinc coating provides excellent corrosion resistance. The panels are attached to the structure by a clip and sliding tab assembly, which allows the roof to expand and contract due to changing temperature. The 360 degree double seam lock with factory applied mastic ensures the highest standard of weather-tightness integrity. The MR-24[®] is suitable for roof slopes from 1.2 degrees (1:48) to 26.6 degrees (1:2).

Insulation thickness (mm)	100	120	160	200
U value (W/m ² K)	0.35	0.30	0.23	0.19

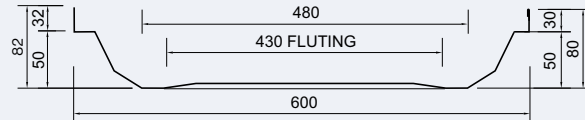

LTP 38

LTP 38 is a 1000 mm wide factory roll-formed panel with four 38 mm high by 69 mm wide major corrugations. The distance between the major corrugations is 333 mm. The flat of the panel contains two additional minor vee corrugations. The panels are attached to the structure with stainless steel self-drilling screws (in less corrosive atmospheres painted carbon steel screws are used). The panel endlaps are factory pre-punched to ensure accurate alignment, and provide for expansion and contraction. The sidelap has a sealant groove to ensure a watertight lap. The panel is produced in 0.55 mm thick aluminum/zinc coated steel 0.5 and 0.6 mm thick polyester pre-painted steel and 0.6 mm Top Coat high built polyester pre-painted steel. The LTP 38 is suitable for roof slopes from 2.4 degrees (1:24).

Insulation thickness (mm)	100	120	160	200
U value (W/m ² K)	0.35	0.31	0.24	0.19

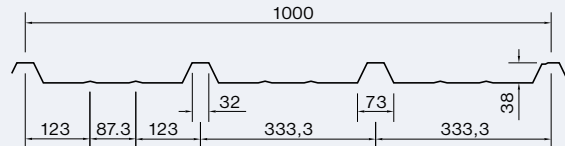

LTP 45

LTP 45 is a 900 mm wide factory roll-formed panel with five 45 mm high by 77 mm wide major corrugations. The distance between major corrugations is 180 mm. The panel thickness is 0.5 mm or 0.6 mm and is available in polyester pre-painted steel, or Top Coat, hardened polyester pre-painted steel. See Colour Chart for colour selection. Panels are fixed to the structure by self-drilling screws. Sidelaps are joined using self-drilling screws. The LTP 45 is suitable for roof slopes from 6 degrees (1:24).

Insulation thickness mm/purlin height	120/120	120/200	150/165	150/200
U value (W/m ² K)	0.41	0.40	0.35	0.34

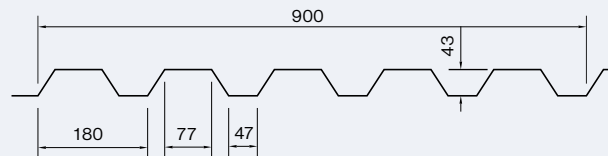

INTERIOR PANELS:

LVP 20

LVP 20 is a 1035 mm wide factory roll-formed panel with nine 18 mm high by 65 mm wide major corrugations. The distance between major corrugations is 115 mm. The material is 0.4 mm thick white (RAL9010) polyester pre-painted steel. For greater sound reduction LVP 20 is available in 0.5 mm thick 35% perforated material, providing up to 25.5DB airborne sound inhibition

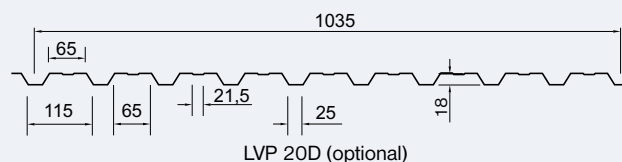
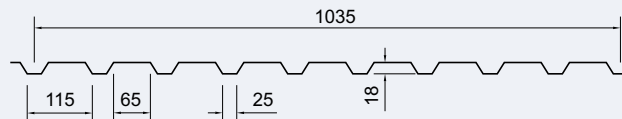

Liner 1000 and Liner 900

Liner 1000 is a 1000 mm wide (900 mm for Liner 900) factory roll-formed panel with three 19 mm high by 64 mm wide major corrugations. The distance between major corrugations is 333 mm (300 mm for Liner 900). The material is 0.4 mm thick white (RAL9010) polyester pre-painted steel.

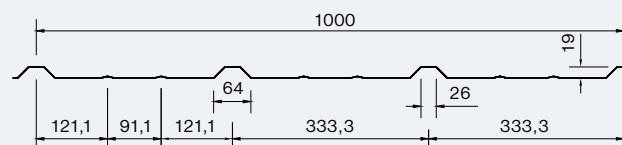

MR-24[®]

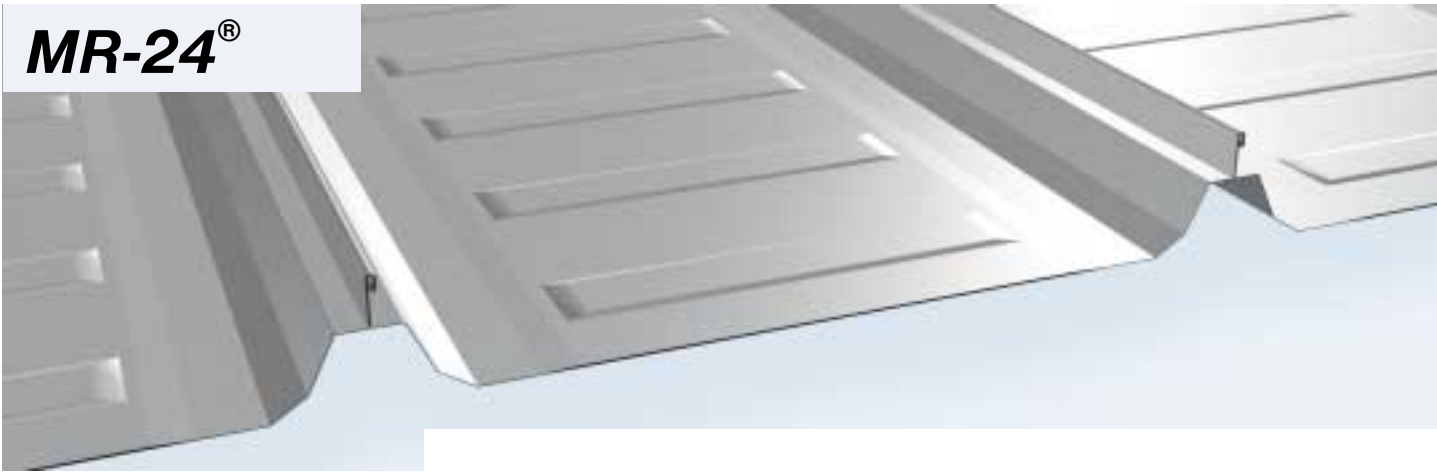

LTP 38

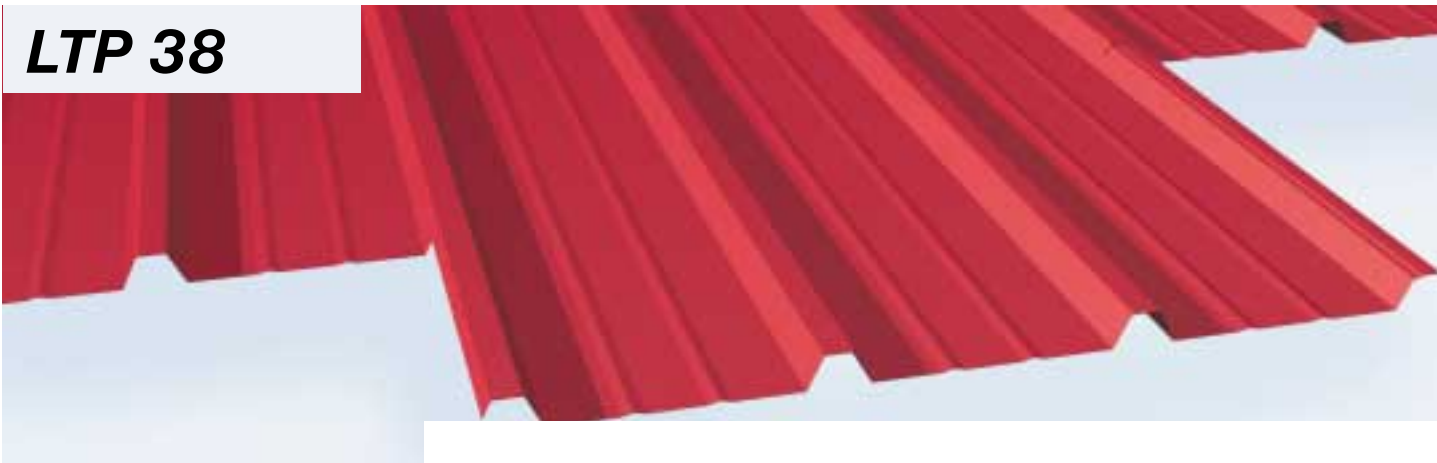

LTP 45



LVP 20

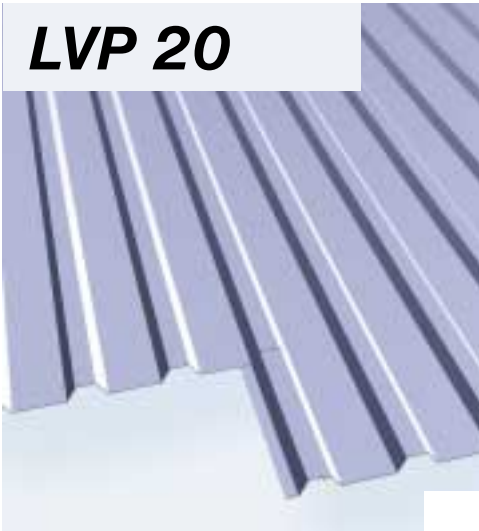

Liner 1000 and Liner 900

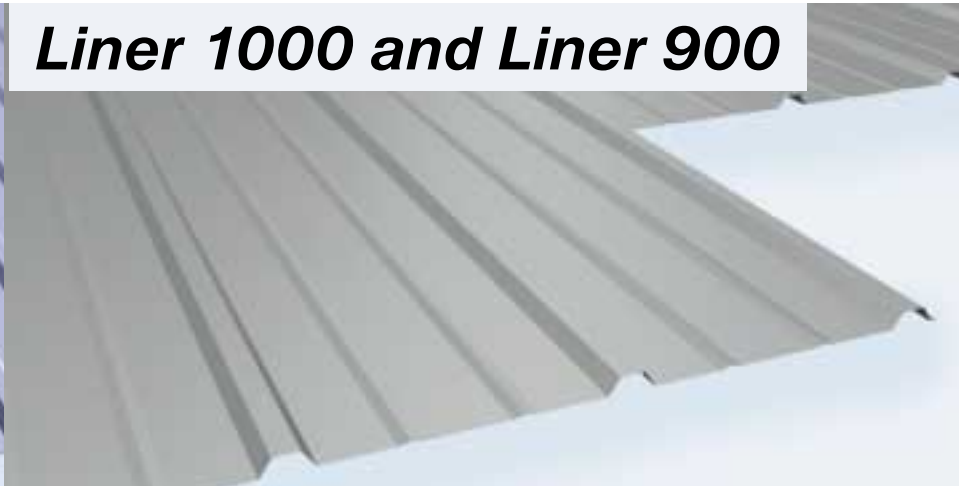

MR-24[®] ROOF SYSTEM

The ultimate in weather protection



Roll Forming Sequence

The MR-24[®] panels are attached to the structure with a special clip and tap assembly roll-formed into the double-lock seam to create a permanent mechanical connection.

The exclusive Pittsburgh double-lock standing seam assures you of consistent weather tight performance.

The floating clip system allows virtually friction-free linear expansion and contraction.

Lateral expansion and contraction is accommodated through the "bellows" action of the major corrugations.

Precision engineered components and an uncompromising commitment to quality assures the integrity of the total system.

The MR-24[®] Roof System is the only completely integrated roll-formed metal roofing membrane available on the market.



MR-24[®] is one of the few roof systems available where a panel splice can be incorporated without compromising the integrity of the roof. Factory pre-punched holes and pre-cut notches allow the panels to be nested together and joined via a panel splice plate and reinforcing strap. Endlaps, when required, are staggered so as to avoid a four panel lap splice condition.



LTP 38 and LTP 45 ROOF SYSTEMS

Engineered to be energy efficient and economical to install and maintain.

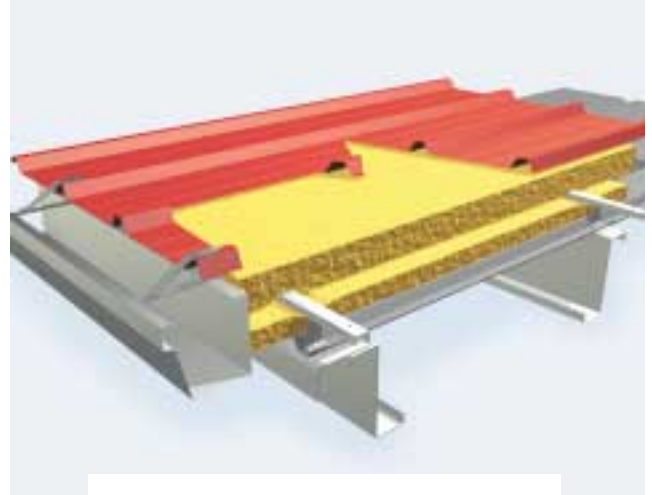
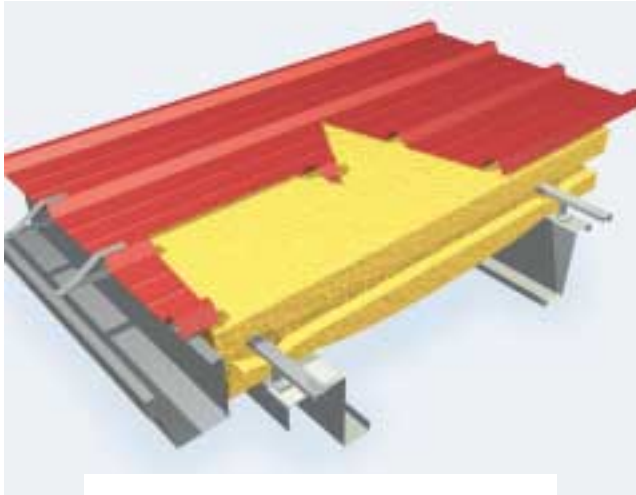

The LTP 38 and LTP 45 Roof Systems can accommodate up to 200 mm fibreglass insulation. Thicknesses greater than 80 mm require the use of the Insulation Bridge to avoid compression of the insulation over the purlins.

LTP 38 and LTP 45 with interior liner panel and Insulation Bridge can accommodate from 80 mm to 200 mm un-faced insulation.

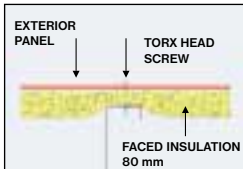

U value = 0.63 W/m²K

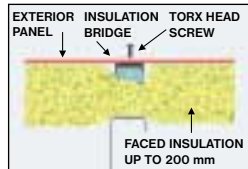

Insulation (mm)	100	120	200
U value (W/m ² K)	0.4	0.33	0.21

Insulation thickness (mm)	80	100	120	200
U values (W/m ² K)	0.47	0.38	0.32	0.19

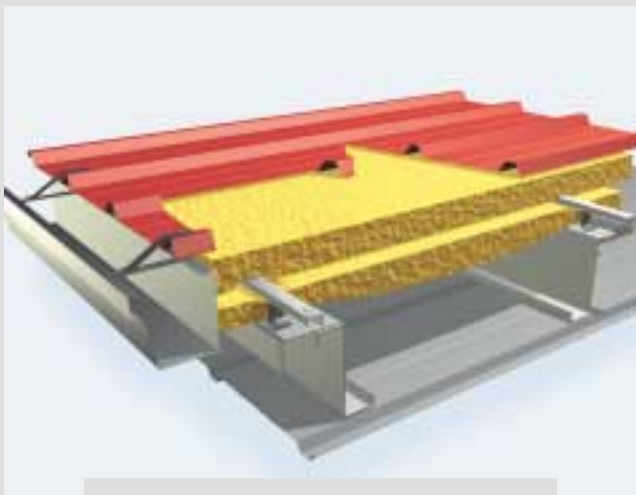
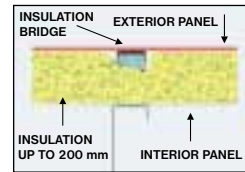

LTP 38 and LTP 45 with interior liner panel installed on the underside of the roof purlins. This system can accommodate from 80 mm to 300 mm faced fibreglass insulation.

LTP 38 panels are factory pre-punched to provide for expansion and contraction and panel alignment during construction. The sidelap has a sealant groove for the precise placement of the sealant.

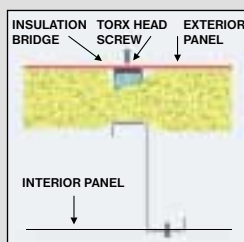



Contour Gable Trim

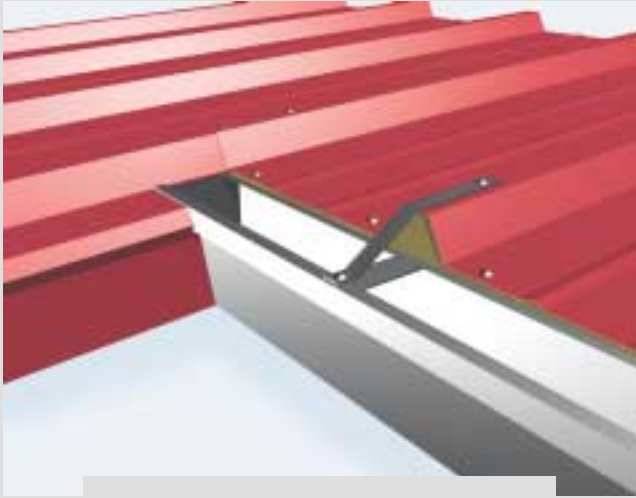

Exterior Gutter



MR-24[®] Ridge Detail

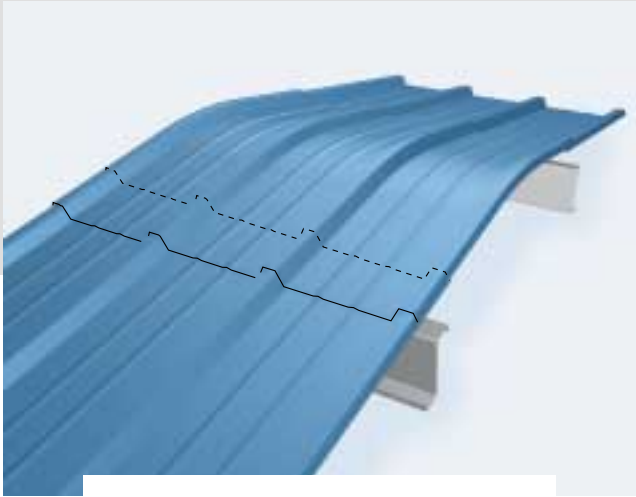

LTP 38 Curved Ridge Cap

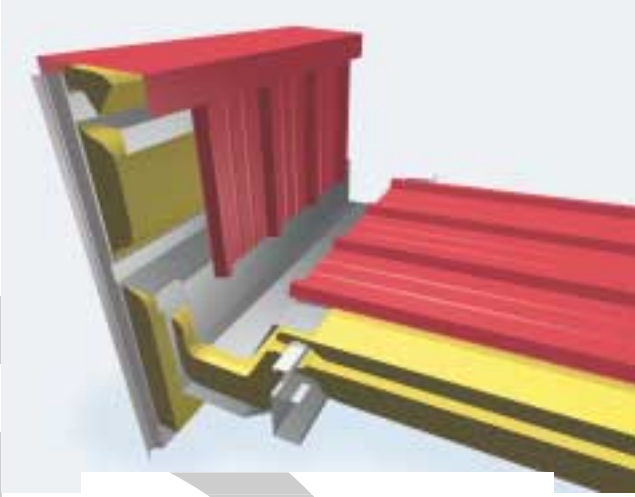

Parapet Detail

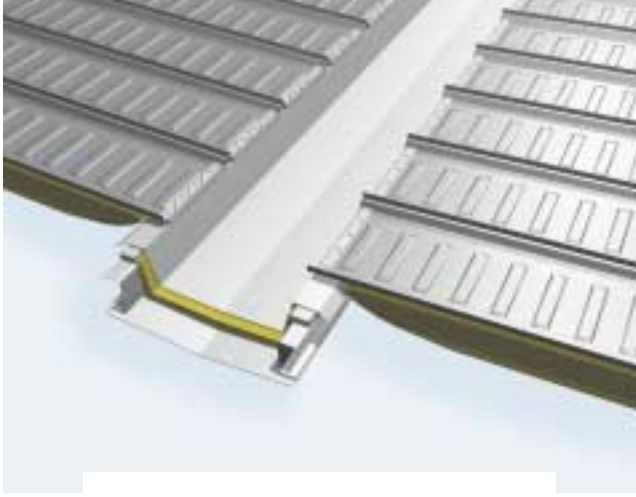

Interior Gutter